

SP Series

SP12-26(F) 12V26Ah



SP series VRLA battery uses AGM technology and high-purity raw materials. Its good floating back up and large current discharge performance makes it optimal and economical choice for UPS/EPS.

Benefits

- Long life according to EUROBAT Classification
- Maximum charge efficiency
- High gas recombination efficiency
- Low self-discharge rate
- Easy installation and handling
- Vertical or horizontal installation

Applications

- UPS units
- Emergency power
- Starting generators
- EPS units

Standards

- IEC 61056-1/2
- JIS C8702-1/2
- EUROBAT guide

Drawing

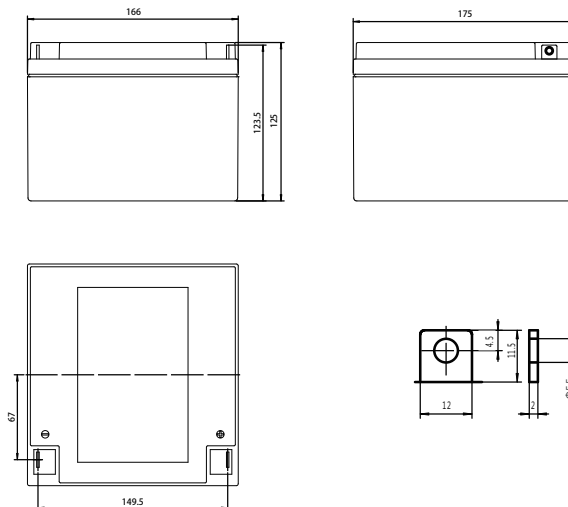

Specifications

| | | | | |
|--------------------------------------|--|---------------------|-----------------------|--------------------|
| Battery Model | SP12-26(F) | | | |
| Design Life (years, 25°C) | 10 | | | |
| Capacity (Ah, 25°C) | 20HR (1.3A, 1.75V) | 10HR (2.42A, 1.75V) | 5HR (4.74A, 1.75V) | 1HR(16.37A, 1.70V) |
| | 26 | 24.2 | 23.5 | 16.37 |
| Dimensions (mm) | Length | Width | Height | Total Height |
| | 166 | 175 | 125 | 125 |
| Approx. Weight (kg) | 8.0 | | | |
| Reference Internal Resistance (mΩ) | 8.8 (full charged @ 25°C) | | | |
| Maximum Discharge Current (A/5 Sec.) | 390 | | | |
| Self-Discharge (25°C) | < 3% per month | | | |
| Charge Voltage (V/cell, 25°C) | Cycle use | | Float use | |
| | 2.45 (-3.5mV/°C/cell), max charge current: 7.8 A | | 2.27 (-3.5mV/°C/cell) | |
| Short Circuit Current (A) | 670 | | | |

Discharge Data

| Constant Current Discharge Data (25°C, A) | | | | | | | | | | | | |
|---|-------|-------|-------|-------|-------|-------|-------|-------|-------|-------|-------|-------|
| End Voltage (V/cell) | min | | | | | h | | | | | | |
| | 10 | 15 | 20 | 30 | 45 | 1 | 1.5 | 2 | 3 | 5 | 10 | 20 |
| 1.60 | 63.26 | 50.31 | 41.07 | 29.20 | 20.62 | 16.72 | 11.90 | 9.620 | 7.140 | 4.779 | 2.456 | 1.317 |
| 1.65 | 61.32 | 49.07 | 40.48 | 28.96 | 20.45 | 16.61 | 11.83 | 9.553 | 7.102 | 4.757 | 2.447 | 1.312 |
| 1.67 | 59.79 | 48.36 | 39.98 | 28.67 | 20.29 | 16.50 | 11.76 | 9.509 | 7.073 | 4.739 | 2.438 | 1.308 |
| 1.70 | 58.36 | 47.61 | 39.47 | 28.35 | 20.09 | 16.37 | 11.68 | 9.451 | 7.032 | 4.717 | 2.427 | 1.303 |
| 1.75 | 56.94 | 46.80 | 39.00 | 28.08 | 19.93 | 16.26 | 11.61 | 9.404 | 7.003 | 4.701 | 2.420 | 1.300 |
| 1.80 | 53.30 | 44.65 | 37.71 | 27.35 | 19.49 | 15.96 | 11.42 | 9.307 | 6.947 | 4.670 | 2.405 | 1.294 |

| Constant Power Discharge Data (25°C, W/cell) | | | | | | | | | | | | |
|--|-------|-------|-------|-------|-------|-------|-------|-------|-------|-------|-------|-------|
| End Voltage (V/cell) | min | | | | | h | | | | | | |
| | 10 | 15 | 20 | 30 | 45 | 1 | 1.5 | 2 | 3 | 5 | 10 | 20 |
| 1.60 | 118.6 | 96.04 | 79.25 | 56.75 | 40.32 | 32.86 | 23.48 | 19.05 | 14.18 | 9.520 | 4.909 | 2.636 |
| 1.65 | 115.4 | 93.92 | 78.37 | 56.43 | 40.11 | 32.74 | 23.41 | 18.96 | 14.15 | 9.498 | 4.902 | 2.634 |
| 1.67 | 112.9 | 92.86 | 77.68 | 56.06 | 39.91 | 32.59 | 23.31 | 18.92 | 14.12 | 9.485 | 4.895 | 2.633 |
| 1.70 | 110.7 | 91.68 | 76.81 | 55.54 | 39.58 | 32.40 | 23.20 | 18.84 | 14.06 | 9.458 | 4.880 | 2.627 |
| 1.75 | 108.4 | 90.38 | 76.08 | 55.12 | 39.35 | 32.23 | 23.12 | 18.78 | 14.03 | 9.445 | 4.877 | 2.626 |
| 1.80 | 101.9 | 86.52 | 73.76 | 53.84 | 38.60 | 31.73 | 22.80 | 18.64 | 13.96 | 9.404 | 4.858 | 2.619 |

Performance Curve

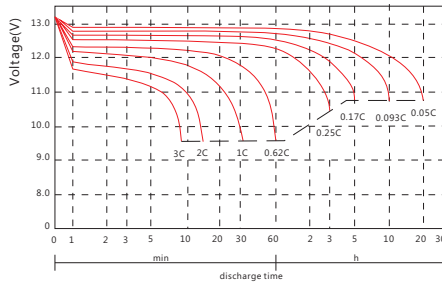

Discharge voltage vs. discharge time

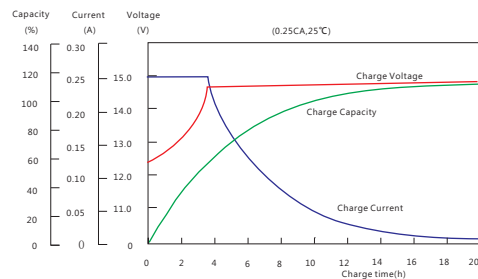

Charge capacity vs. charge time

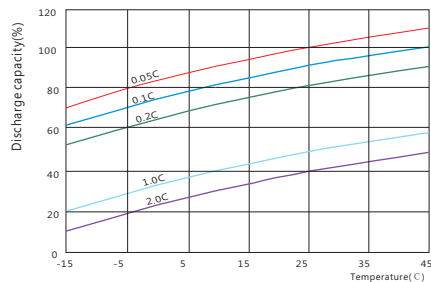

Discharge capacity vs. temperature

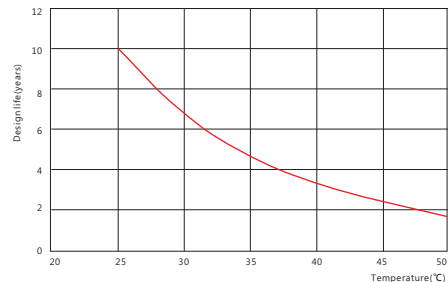

Design life vs. temperature

Sacred Sun Power Sources Co., Ltd.

Add: No.1 Shengyang Road, Qufu 273100 PRC
Tel: +86-537-4422313 Fax: +86-537-4411980
Email: sales@sacredsun.cn

Sacred Sun Hong Kong Co., Limited

Add: RM 19C Lockhart CTR 301-307 Lockhart RD Wan Chai, Hong Kong
Email: admin.hk@sacredsun.hk

Sacred Sun Asia Pacific Pte Ltd.

Add: 1 Ubi View, #04-12, Focus One, Singapore 408555
Email: admin.sg@sacredsun.sg

Sacred Sun Europe SARL

Add: ZAE Fontaine, 33210 Fargues, France
Email: admin.eu@sacredsun.eu

Sacred Sun MEA FZE

Add: No. 311 office, Building LOB 14, JAFZA, Dubai, UAE
Email: admin.ae@sacredsun.ae

